



Declaration of Performance

Identification Code: VW-150-STST

Meeting the requirements of Annex ZA, EN 845-1:2003+A1:2008 Bed Joint Reinforcement defined in 4.2.2 of the standard

Description of Use:

Asymmetrical wall tie used to connect new masonry cladding to cast in or surface

Testing Body:	Lucideon Ltd Queens Road Penkull Stoke on Trent ST4 7QL
Notification Body No:	1289

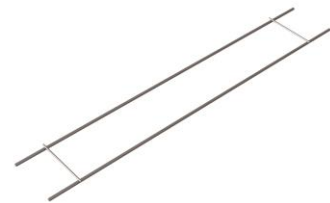

Performance:

Shear Load Capacity:	2700mm +/- 1.5%
Width:	150mm +/- 1.5mm
Profile Height:	4.0mm +/- 0.4mm
Longitudinal Wire Size:	3.6mm +/- 0.1mm
Cross Wire Size:	2.5mm +/- 0.1mm
Pitch of Cross Wires:	450mm +/- 3.0%
Characteristic Yield Strength:	500N/mm ²
Bond Strength:	4710N
Lap Strength:	225mm
Shear Load Capacity Welds:	4306N
Ductility:	Normal
Minimum Mortar Joint:	R3 (stainless steel)
Dangerous Substances:	None

**UK
CA**

Authorised Signature

Philip Travis, Managing Director

21st March 2023