

# TLPERSMESH Base Track Clip-on Drip Bead

Data sheet

Issue Date:  
June 2026

## PVC-u Beads

PVC-u beads are now being used more and more, particularly in areas of high rainfall or extreme damp conditions. They provide an economical alternative to stainless steel products and are used in the same way as normal galvanised or stainless steel beads. They are manufactured from white high density polyvinylchloride high impact window grade material. Other colours are available and manufactured to order. The face of the bead is ribbed and perforated to produce a good plaster or mortar key and can be easily cut to size using a hacksaw.

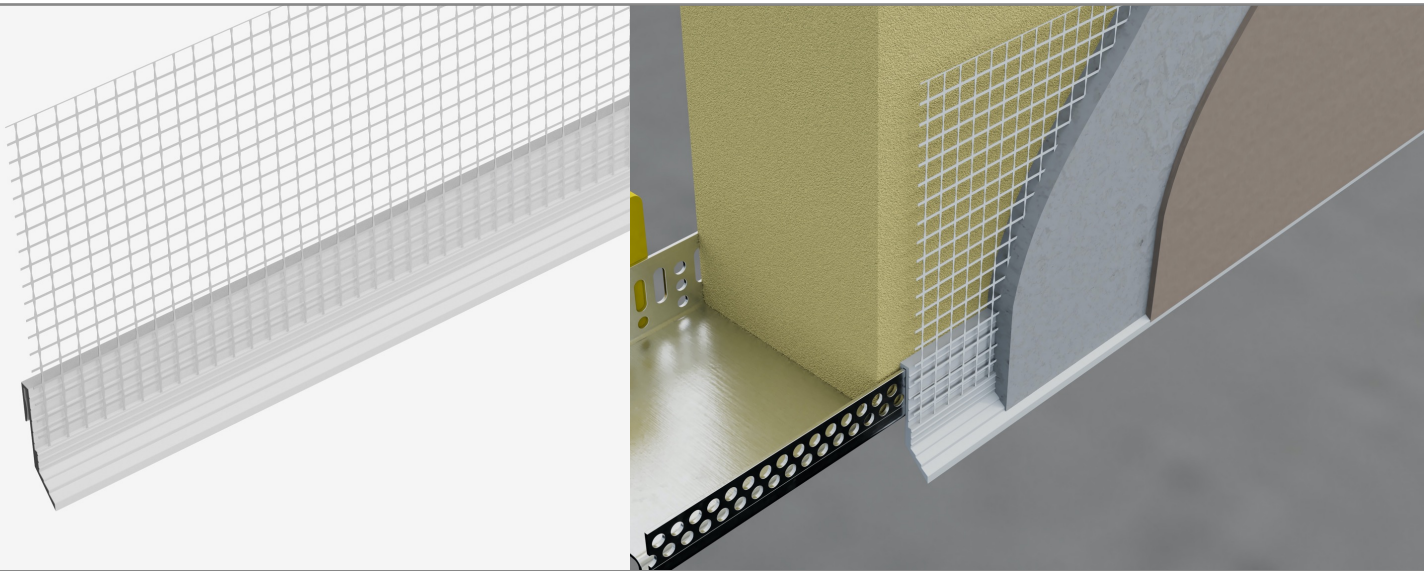

## TLPERSMESH Base Track Clip-on Drip Bead

A PVC clip on profile drip bead with fibre-glass mesh used for clipping onto EWI base starter track to provide a neat drip edge for rendering into. This bead provides suitable water drainage from the surface preventing travel back towards the wall and possible damp issues. The mesh works to combine the track with reinforcement mesh which increases the durability and strength of the system.

### Benefits

- Simple installation (with plaster dabs or appropriate fixings)
- Cost effective
- Easy to cut (by use of tin snips or fine tooth saw)
- Non corrosive

**Standard:** Meets the equivalent standards required for metal bead to BS EN 13658-2:2005

**Material:** Exterior grade impact resistant UV stable unplasticized PVC-u

Code	Size	Per Box	Weight
TLPERS0625MESH	2.5m x 6mm render depth	20 lengths	6kgs

Goods to be stored and transported laying down and in dry conditions.

Please dispose or recycle in accordance with waste management regulations.

### COSHH & Health & Safety.

Contains no substances hazardous to health. The comparative rough surface finish and sharp edges requires care when handling manually, to avoid risk of cuts and abrasions gloves should be worn.